

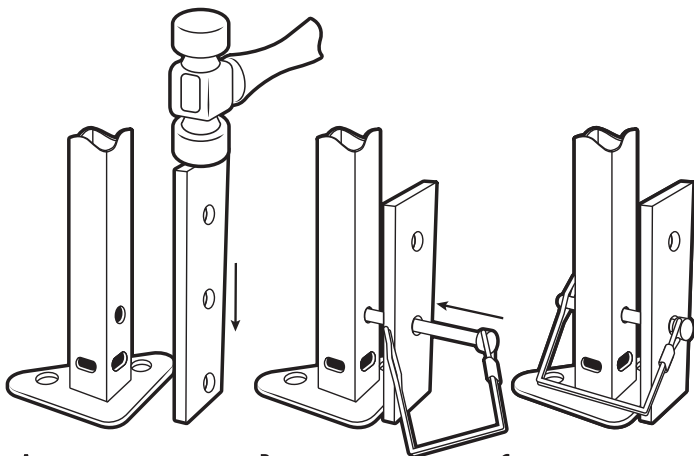

# Heavy-Duty Stake Kit

## SET-UP INSTRUCTIONS

**Always stake or weight down your E-Z UP® portable shelter. Take down if heavy winds or rain threaten. Do not leave your E-Z UP® portable shelter unattended.**



**A.**

Set up the shelter in the desired location. Determine where to place the first stake. Move the E-Z UP® shelter leg slightly to the side, then drive the stake firmly into the ground with a mallet or hammer leaving one of the holes in the stake about an inch above the surface.

**B.**

Insert the quick release pin into the hole in the stake and through the E-Z UP® shelter leg.

**C.**

Swing the wire catch around to secure onto the end of the pin protruding from the leg. Repeat steps at each of the other legs of the shelter. For larger shelters, use stakes on all legs.

**NOTE:** For best results, drive the stake as far as possible into the ground.

### **WARNING!**

Do not depend on stake kits to secure shelter in heavy winds. For safety, take your E-Z UP® portable shelter down.

**800-45-SHADE**

**ezup.com**